

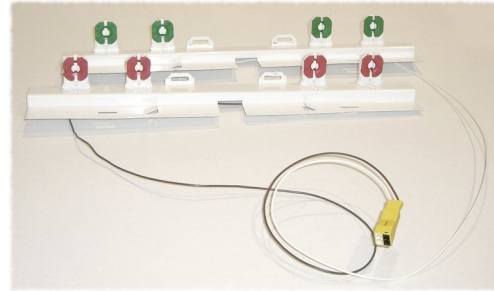

Installation Instructions

ETRK4LX824 – 4ft Troffer Fixture Upgrade Kit
ETRK4LX822 – 2ft Troffer Fixture Upgrade Kit



Kits ship with sockets pre-wired and mounted to socket bars.

Materials List

- [4] - **TSLX8-LR** Red Tube Sockets (Line)
- [4] - **TSLX8-NG** Green Tube Sockets (Neutral)
- [2] - Socket Brackets
- [1] - Black Wires 60-inch - (ETRK4LX824)
-or-
- [1] - Black Wires 30-inch – (ETRK4LX822)
- [1] - White Wires 60-inch – (ETRK4LX824)
-or-
- [1] - Black Wires 30-inch – (ETRK4LX822)
- [1] - Black Wires 11-inch
- [1] - White Wires 11-inch
- [2] - Black Wires 5-inch
- [2] - White Wires 5-inch
- [1] - **LDPI** Luminaire Disconnect
- [4] - Tek Screws (#8)
- [1] - 4' Faceted Reflector - 91% Reflectance – (ETRK4LX824)
-or-
- [1] - 2' Faceted Reflector - 91% Reflectance – (ETRK2LX822)
- [1] - LED Conversion Notice Sticker
- Illustrated Instruction Sheet
- Wiring Diagram*

***EcoHX LED Conversion Kits** are shipped with sockets pre-wired and installed onto the socket bars. Wiring diagrams are provided for reference. Digital copies of instructions and wiring diagrams are available for download at www.HXLightinginc.com.

Applications

Pre-wired conversion kits are intended for use only with **EcoHX X8™ Touch-Safe** Type B Double-end tubes. **EcoHX X8™ Touch-Safe** tubes are UL Certified, include anti-shock technology, and feature glass construction to eliminate sagging and discoloration. Tubes are available in *EXP*, *Outdoor*, *Cool* and *Natural* color. **HX Lighting does not support the use of any other tubes in pre-wired conversion kits.**

Precautions

WARNING! - Read instructions thoroughly before beginning installation. If you are at all unsure of any of the following instructions and precautions, consult a qualified electrical contractor to perform the conversion for you.

RISK OF ELECTROCUTION! – Disconnect power at fuse or breaker panel before attempting any electrical work. Verify that there is no power on the circuit before proceeding with fixture modifications. To prevent wiring damage or abrasion, do not expose wiring to edges of sheet metal or other sharp objects. **Conversion kits are not for use in damp or wet locations.**

RISK OF FIRE! - Supply wires must be rated 90°C or greater.

ALWAYS follow electrical code requirements specific to your area. Before undertaking an electrical project, contact your local electrical authority and your insurance company to ensure that you comply with all policies, warranties, regulations and authorities concerning this work.

WARNING! - Disconnect power at fuse or breaker panel before beginning any electrical work. Verify that there is no power on the circuit before proceeding with fixture upgrade. LED upgrade kit installation requires knowledge of lighting fixture electrical systems. **If you are at all unsure of any of the following instructions hire a qualified electrical contractor to perform the service for you.**



Remove the cover from the fixture and set aside for re-installation.



Remove the existing fluorescent tubes from the fixture and set them aside for proper disposal.

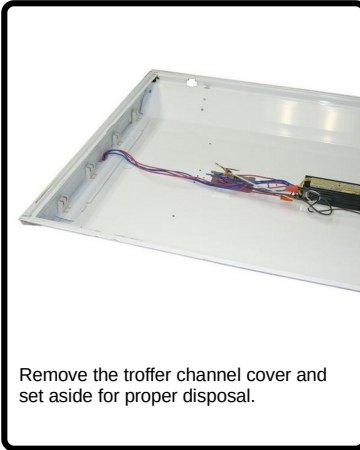

Remove the troffer channel cover and set aside for proper disposal.

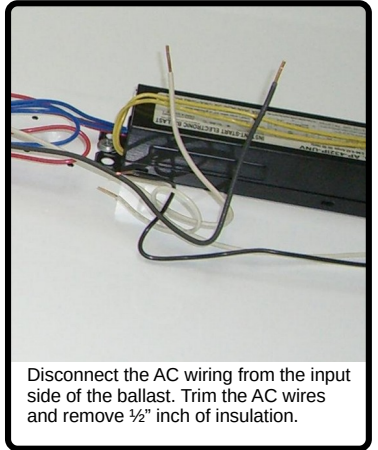

Disconnect the AC wiring from the input side of the ballast. Trim the AC wires and remove 1/2" inch of insulation.

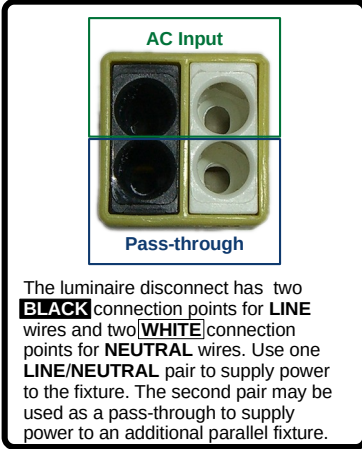

The luminaire disconnect has two **BLACK** connection points for **LINE** wires and two **WHITE** connection points for **NEUTRAL** wires. Use one **LINE/NEUTRAL** pair to supply power to the fixture. The second pair may be used as a pass-through to supply power to an additional parallel fixture.

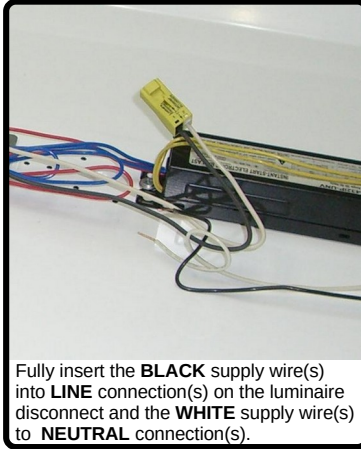

Fully insert the **BLACK** supply wire(s) into **LINE** connection(s) on the luminaire disconnect and the **WHITE** supply wire(s) to **NEUTRAL** connection(s).

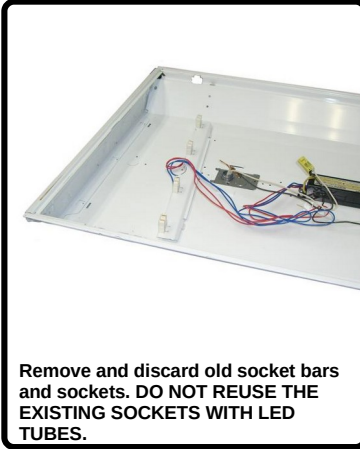

Remove and discard old socket bars and sockets. **DO NOT REUSE THE EXISTING SOCKETS WITH LED TUBES.**

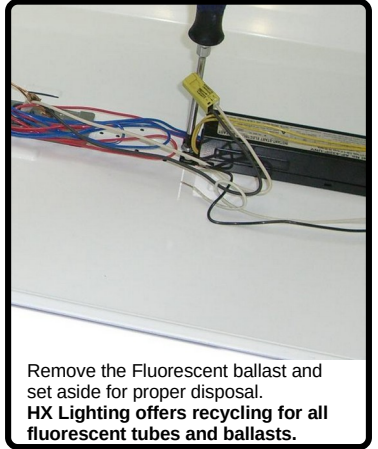

Remove the Fluorescent ballast and set aside for proper disposal. **HX Lighting offers recycling for all fluorescent tubes and ballasts.**

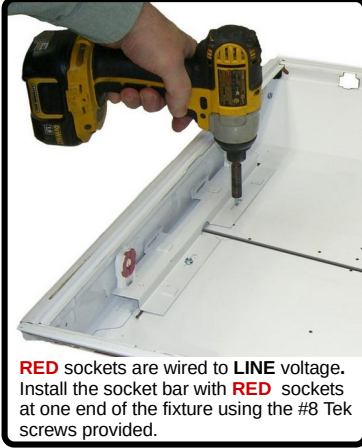

RED sockets are wired to **LINE** voltage. Install the socket bar with **RED** sockets at one end of the fixture using the #8 Tek screws provided.



GREEN sockets are wired to **NEUTRAL**. Install the socket bar with **GREEN** sockets at the opposite end of the fixture using the #8 Tek screws provided.

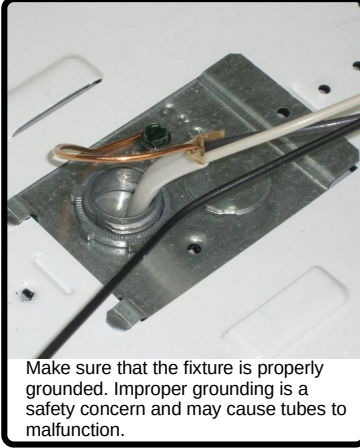

Make sure that the fixture is properly grounded. Improper grounding is a safety concern and may cause tubes to malfunction.

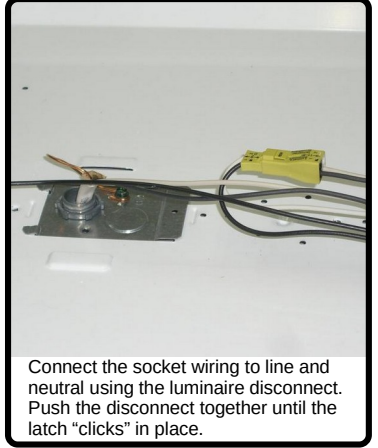

Connect the socket wiring to line and neutral using the luminaire disconnect. Push the disconnect together until the latch "clicks" in place.

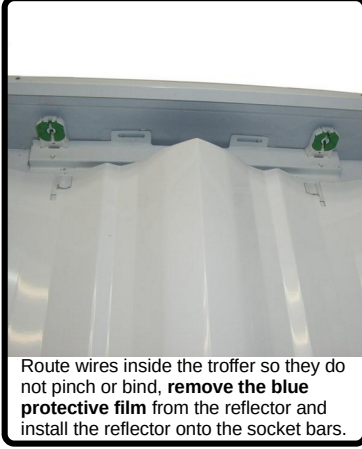

Route wires inside the troffer so they do not pinch or bind, **remove the blue protective film** from the reflector and install the reflector onto the socket bars.



Attach the LED Conversion Sticker to the faceted reflector.

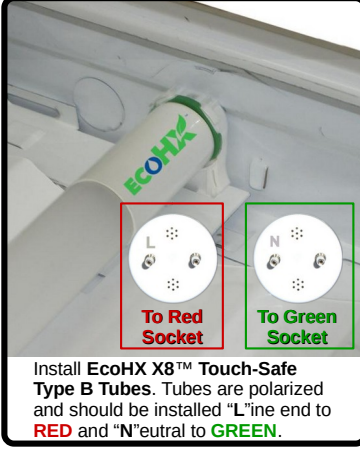

Install **EcoHX X8™ Touch-Safe Type B Tubes**. Tubes are polarized and should be installed "L"ine end to **RED** and "N"eutral to **GREEN**.



Re-install the fixture cover.